

4" Wide Housing

Product Features

Edgeline series architectural linear luminaire housing from 4" wide aluminum extruded profile, available in 2, 4 and 8-Ft length with Black, White finish; aircraft steel cable suspension system for direct ceiling mounting, with power supply unit integral inside fixture, and power feed cable through junction box cover plate; integral driver, frosted polycarbonate lens; emits even soft direct, direct/indirect facing light for general illumination; >90CRI LED; field selectable CCT in 2700K / 3000K / 3500K / 4000K / 5000K; 70% of luminous flux after 100,000 hours; cULus damp location listed; universal input 120-277V power supply with 0-10V dimming and a 0-100% dimming range. Tunable White and Dim-to-Warm options available.

Technical Specifications

INPUT VOLTAGE	Universal Input AC120-277V
FREQUENCY	50/60hz
COLOR TEMPERATURE	Field Selectable 2700K / 3000K / 3500K / 4000K / 5000K, Dim-to-Warm, Tunable White
COLOR RENDERING INDEX	>90
DISTRIBUTION	Direct/Indirect Ratio Field Selectable 100%, 70%/30%, 50%/50%, 30%/70%, 100%
IP RATING	Damp Location
LIFE SPAN	>100,000 Hours
DIMMING	0-10V Dimming with 0-100% Dimming Range



EDGE LINE SERIES | EDGE LINE 4"

SUBMITTAL WORKSHEET

Order Code Example: EGL4 - L2 - 9SC - BK - GD - UD - EMB-8W-B

A B C D E F G

A SERIES (CHOOSE ONE)

EGL4 Edgeline Series 4" Profile Architectural Linear

B SIZE & OUTPUT (CHOOSE ONE)

CODE	LENGTH	DISTRIBUTION	POWER & LUMEN FIELD SELECTABLE
L2 QS	2FT	Direct 100%	12.5W / 19W / 25W
L4 QS	4FT	Direct 100%	25W / 37.5W / 50W
L8 QS	8FT	Direct 100%	50W / 75W / 100W

CODE	LENGTH	DISTRIBUTION	DIRECT/INDIRECT RATIO FIELD SELECTABLE	POWER & LUMEN FIELD SELECTABLE
IL2 QS	2FT	100%, 70%/30%, 50%/50%, 30%/70%, 100%		12.5W / 19W / 25W
IL4 QS	4FT	100%, 70%/30%, 50%/50%, 30%/70%, 100%		25W / 37.5W / 50W
IL8 QS	8FT	100%, 70%/30%, 50%/50%, 30%/70%, 100%		50W / 75W / 100W

C CCT (CHOOSE ONE)

9SC **QS** Field Selectable 2700K / 3000K / 3500K / 4000K / 5000K

D FINISH (CHOOSE ONE)

BK **QS** Black
 WH **QS** White

E DECORATIVE REFLECTOR (CHOOSE ONE - OPTIONAL)

BK **QS** Black
 GD **QS** Gold
 RG **QS** Rose Gold
 SV **QS** Silver
 WH **QS** White



BK



GD



RG



SV



WH

F INPUT (CHOOSE ONE)

UD **QS** 120-277V, 0-10V Dimming
 TW **QS** 120-277V, 0-10V Tunable White Dimming
 DW **QS** 120-277V, 0-10V Dim-to Warm Dimming

G OPTIONS

BAA Assembled in America, Compliant with BAA (COTS)
 SENSOR-KIT-IFS06R **QS** Integral PIR on/off/dimming/photosensing (14V DC Power by Driver)
 EMB-8W-B* **QS** 90-Minute Self-Diagnostic Emergency Battery 8W 100-347VAC Input 170VDC Output

*see page 7 for EMB and sensor spec

EDGE LINE SERIES | EDGE LINE 4"

SUBMITTAL WORKSHEET

Order Code Example: EGL-QM - EGL-L-CON
H I

H MOUNTING (CHOOSE ONE)

- EGL-QM **QS** Quick Mount
EGL-QMT **QS** Quick Mount for T-Grid Ceiling
EGL-WM **QS** Wall Mount

*see page 3 for detail

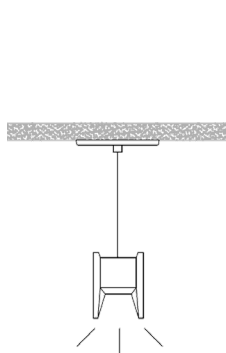

EGL-QM
Quick Mount

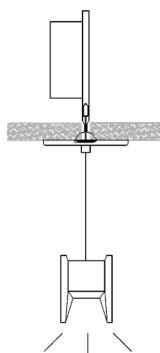

EGL-QMT
Quick Mount
for T-Grid Ceiling

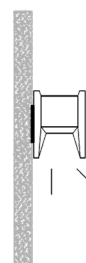



EGL-WM
Wall Mount

I CONNECTORS

- EGL-CON Edgeline Profile Inline Joiner (metal bracket)
EGL-L-CON Edgeline Profile "L" 90° Connector
EGL-X-CON Edgeline Profile "X" 90° Connector
EGL-Y-CON Edgeline Profile "Y" 120° Connector

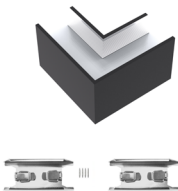
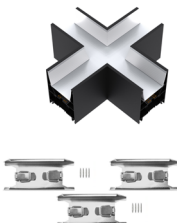
*see page 7 for EMB and sensor spec

EGL-CON EGL Profile Inline Joiner	EGL-L-CON EGL Profile "L" 90° Connector	EGL-X-CON EGL Profile "X" 90° Connector	EGL-Y-CON EGL Profile "Y" 90° Connector
			

EDGE LINE SERIES | EDGE LINE 4"

DIMENSIONS

		EGL2.4		EGL4	
Size	L	W	H	W	H
2FT	26.14"	2.4"	4"	3.98"	5.22"
4FT	49.76"				
8FT	97.01"				

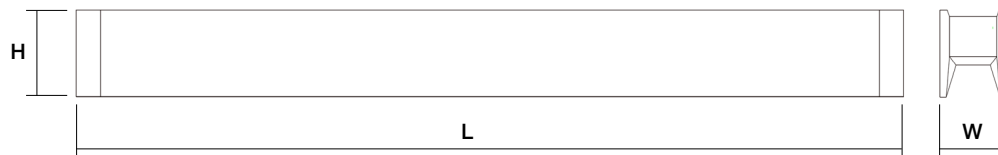

OUTPUT

Selectable CCT

2700K, 3000K, 3500K, 4000K, 5000K

90+ CRI 

Selectable Wattage



Lv1



Lv2



Lv3

Selectable Light Distribution

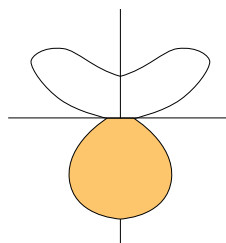

100% Direct

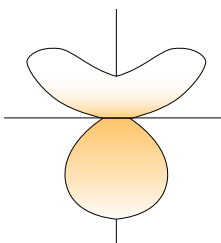

30% Indirect
70% Direct

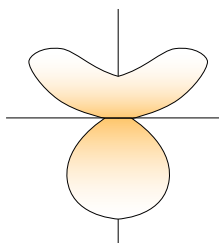

50% Indirect
50% Direct

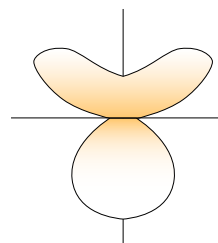

70% Indirect
30% Direct

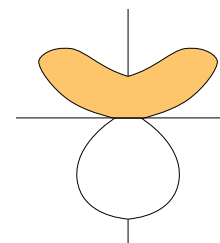

100% Indirect

EDGE LINE SERIES | EDGE LINE 4"

PERFORMANCE DATA

		2700K (90CRI)	3000K (90CRI)	3500K (90CRI)	4000K (90CRI)	5000K (90CRI)
EGL4	Lumens Per Foot	1500	1500	1550	1550	1550
	Input Wattage Per Foot	12.5W	12.5	12.5W	12.5W	12.5W
	Efficacy	120 lm/W	120 lm/W	125 lm/W	125 lm/W	125 lm/W

ELECTRICAL DATA

EDGE LINE 4"				
NUMBER OF DRIVERS	DRIVER CURRENT (mA)	Nominal Power (W)	INPUT VOLTAGE (V)	CURRENT (AMPS)
1	525	25	120	0.21
		25	208	0.12
		25	240	0.10
		25	277	0.09
1	1050	50	120	0.42
		50	208	0.24
		50	240	0.21
		50	277	0.18
1	2100	100	120	0.83
		100	208	0.48
		100	240	0.42
		100	277	0.36

EDGE LINE SERIES | EDGE LINE 4"

PHOTOMETRIC

IES: EGL4-9SC @ 5000K 50W D-100%

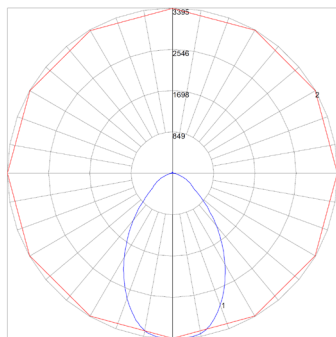

Zone	Lumen	Luminaire%
0-30	2449	37.80
0-40	3747	57.90
0-60	5643	87.20
0-90	6403	98.90
0-180	6472	100

Lumen: 6472
Input Watts: 49.53 W
Efficacy: 131 LPW

IES: EGL4-9SC @ 2700K 50W D-100%

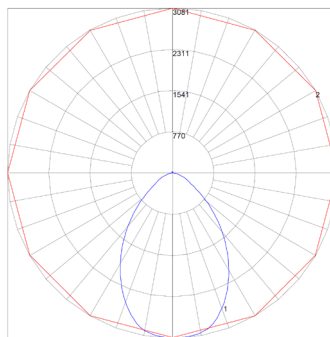

Zone	Lumen	Luminaire%
0-30	2222	37.90
0-40	3398	58.00
0-60	5113	87.20
0-90	5800	98.90
0-180	5863	100

Lumen: 5863
Input Watts: 49.53 W
Efficacy: 118 LPW

IES: EGL4-9SC @ 3500K 50W D-70% I-30%

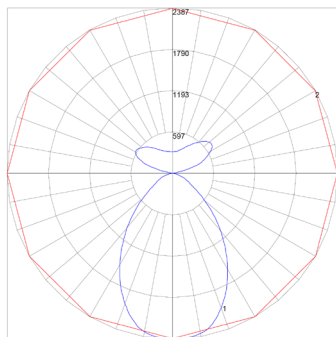

Zone	Lumen	Luminaire%
0-30	1723	27.20
0-40	2636	41.60
0-60	3972	62.70
0-90	4515	71.30
0-180	6334	100

Lumen: 6334
Input Watts: 50.69 W
Efficacy: 125 LPW

EDGE LINE SERIES | EDGE LINE 4"

EMB SPEC

Model	Battery Capacity	Input	Output	Output Power	Operating Temp	Installation
EMB-8W-B	90mins	100-347VAC	170VDC	8W	0°C ~ 50°C 32°F ~ 122°F	Factory or Field Install
EMB-18W-B	90mins	100-347VAC	170VDC	18W	0°C ~ 50°C 32°F ~ 122°F	Factory or Field Install

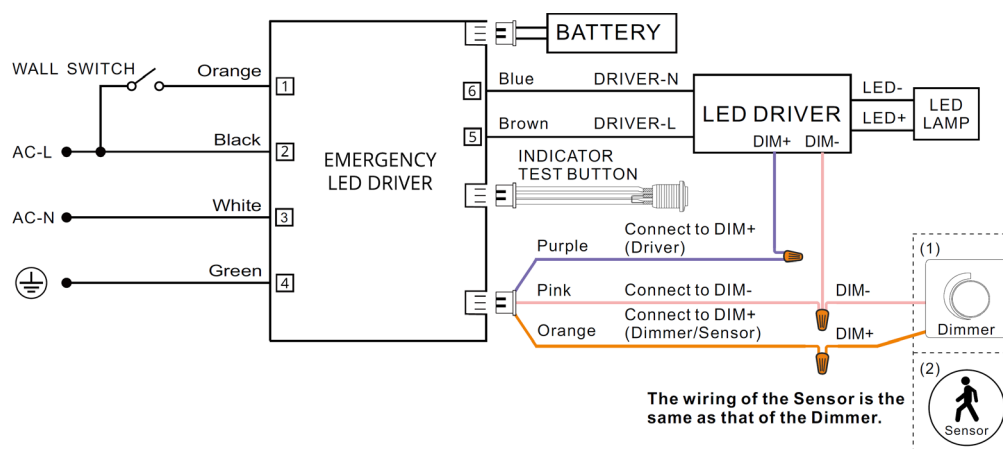

SENSOR SPEC

Model	Type	Mounting	Coverage	Input	Function	Programmable
SENSOR-KIT-IFS06R	PIR Sensor	Integral to Fixture	-	14V DC	On/Off Daylight Harvesting Bi-Level Dimming Adj. Hold Time	-

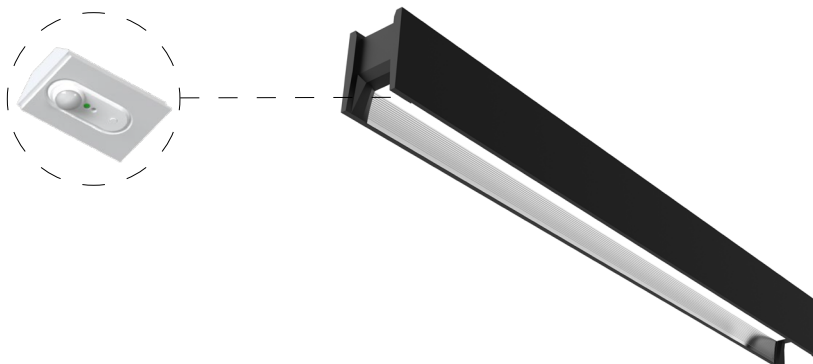

SENSOR-KIT-IFS06R PIR SENSOR

FEATURE

- **Installation:** Factory Install - Sensor Integral to Fixture
- **Commissioning:** through Remote Control
- **Control:** Adjustable Hold Time, Bi-Level Dimming, Manual/Auto - On/Off
- **Sensor:** Motion (Occupancy/Vacancy/Manual) and Daylight Harvesting



SPECIFICATIONS

SENSOR TYPE:	Passive Infrared Sensor (PIR)	COMMISSIONING RANGE:	50FT from Remote Control
INPUT VOLTAGE:	10-14VDC, >50mA	TIME SETTING:	10sec ~ 60min (adjustable)
LIGHT-CONTROL:	Daylight Harvesting with Automatic Dimming	DETECTION ANGLE:	360°
CONTROL OUTPUT:	0-10V, Max. 25mA sinking current	MOUNTING HEIGHT:	12FT Max.
OPERATING TEMP:	-4°F ~ +140°F (-20°C ~ +60°C)	WARRANTY:	5 years
		IP RATING:	IP20

DIMENSIONS

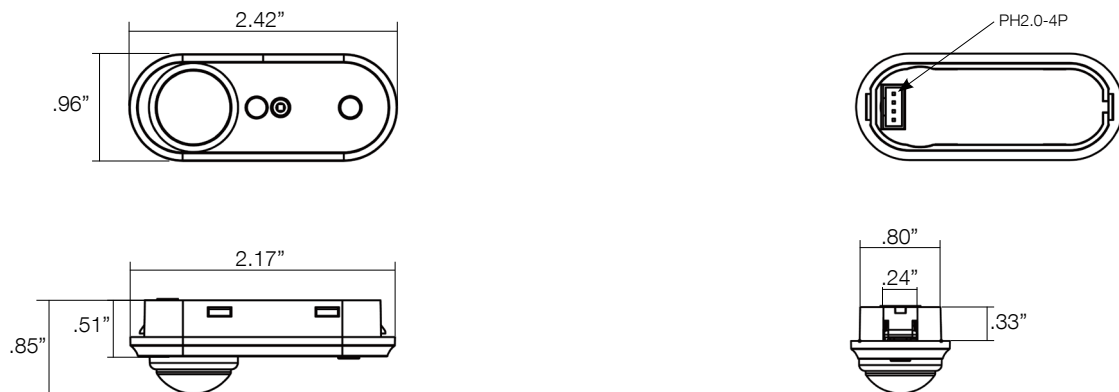

COVERAGE PATTERNS

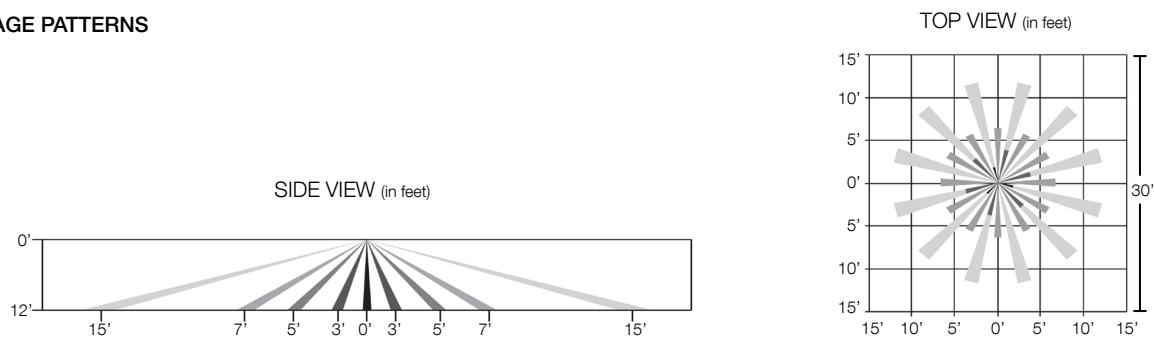

ORDER CODE

EXAMPLE: SENSOR-IFS06R

A

SERIES

SENSOR-KIT-IFS06R Integral PIR on/off/dimming/photosensing (14V DC Power by Driver)

INSTALLATION

QM - Quick Mount Installation

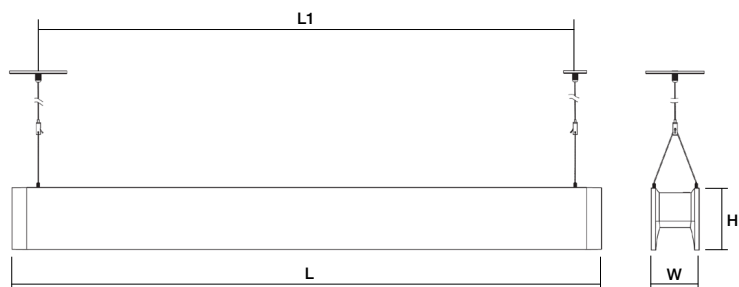

EGL4				
Size	L	W	H	L1 - Installation Spacing
2FT	26.14"	4"	5.22"	19.68"
4FT	49.76"			43.30"
8FT	97.01"			90.55"

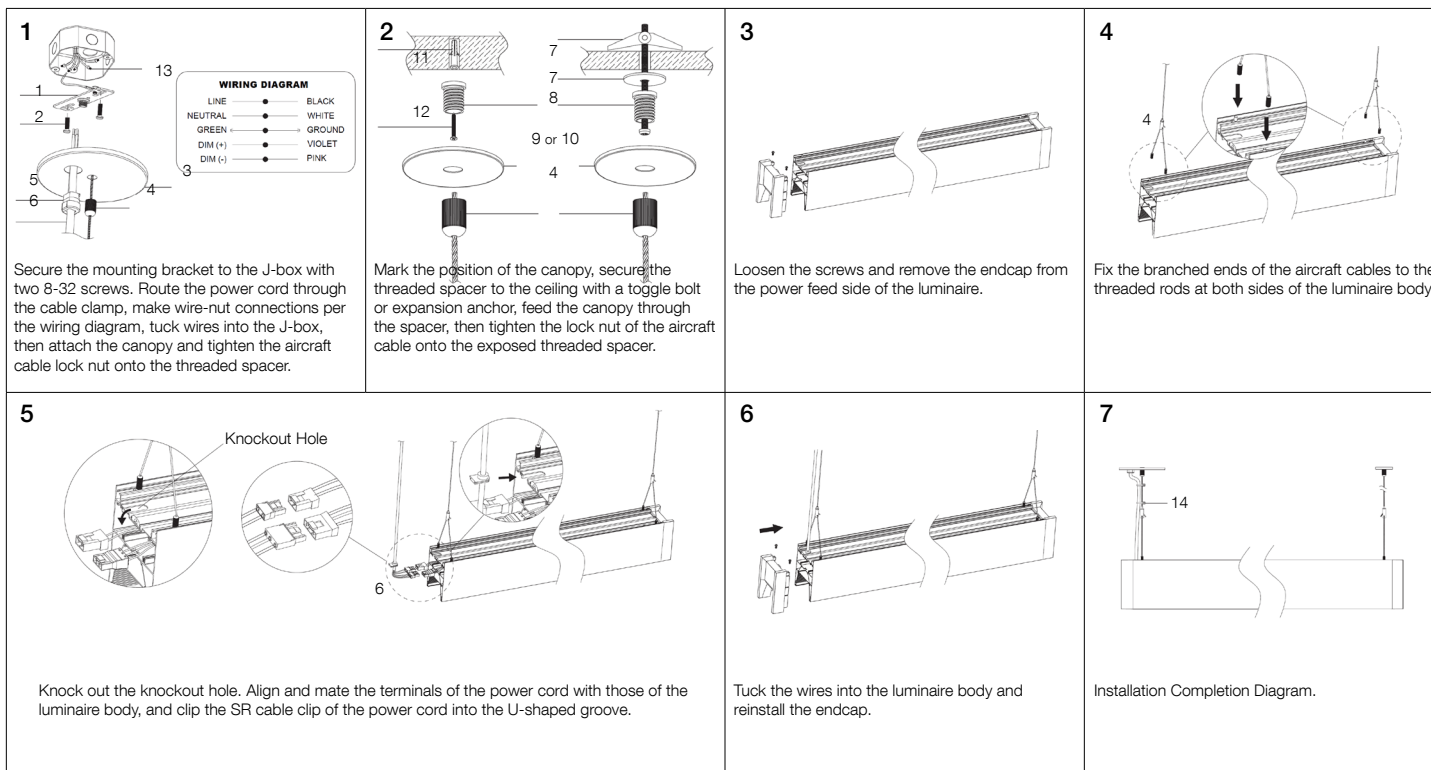
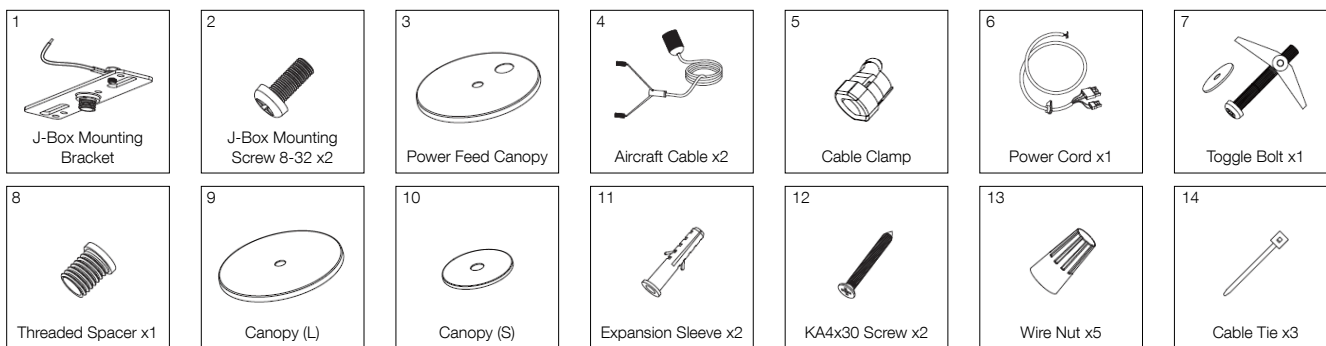

INSTALLATION

QMT - T-Grid Quick Mount Installation

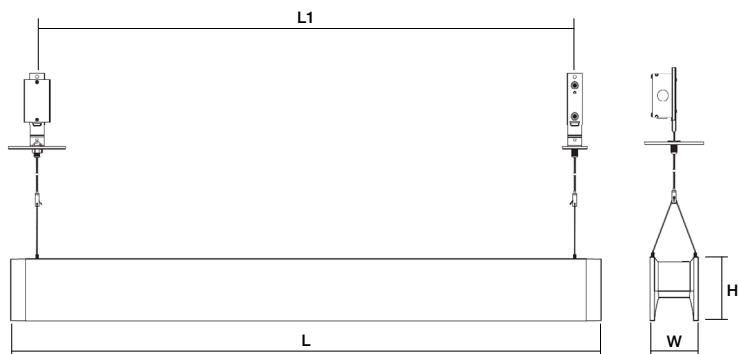

EGL4				
Size	L	W	H	L1 - Installation Spacing
2FT	26.14"	4"	5.22"	19.68"
4FT	49.76"			43.30"
8FT	97.01"			90.55"

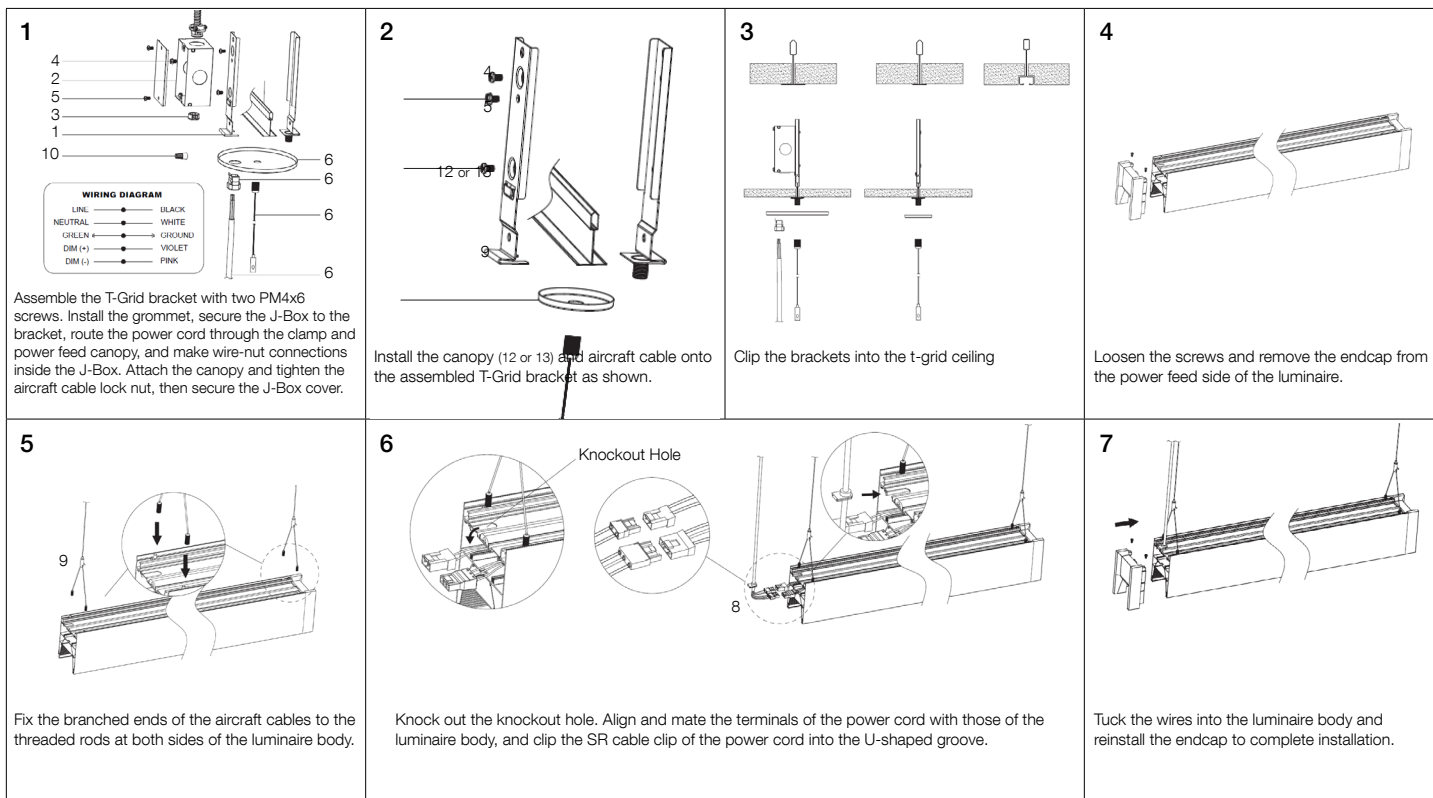
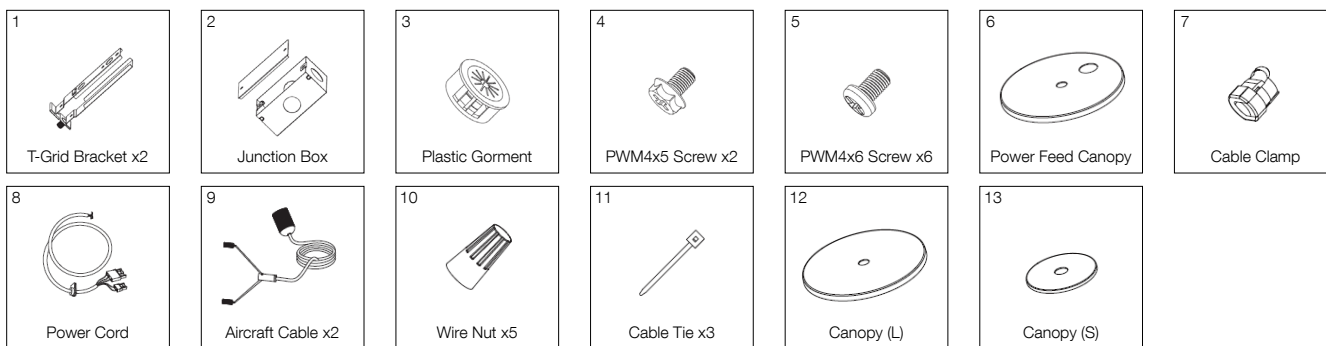

INSTALLATION

WM - Wall Mount Installation

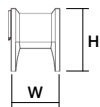
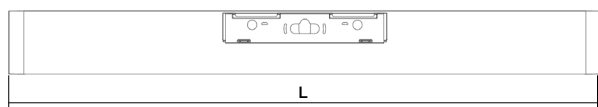

EGL4			
Size	L	W	H
2FT	26.14"	4"	5.22"
4FT	49.76"		
8FT	97.01"		

