

White



Black

**Product Features**

LUMI Series - PLANE - featuring a slim design with clean lines and square forms. Its unique semi-transparent optics provide optimal direct/indirect distribution of 55% downlighting and 45% uplighting, creating the illusion of light floating in mid-air; power over suspension cable system, eliminates the use of power cord; 80CRI; field selectable output 3000 / 4000 / 5000lm setting; field selectable CCT 3000K ~ 4000K; 88% of luminous flux after 50,000 hours; cULus damp location listed; universal power supply with 1% 0-10v dimming.

**Technical Specifications**

|                       |   |
|-----------------------|---|
| INPUT VOLTAGE         | Universal Input AC120-347V                |
| FREQUENCY             | 50/60hz                                   |
| PERFORMANCE OUTPUT    | Field Selectable 3000lm / 4000lm / 5000lm |
| COLOR TEMPERATURE     | Field Selectable CCT 3000K, 3500K, 4000K  |
| COLOR RENDERING INDEX | 80+                                       |
| DISTRIBUTION          | Edgelit, 55% Direct - 45% Indirect        |
| IP RATING             | Damp Location                             |
| LIFE SPAN             | >50,000 Hours                             |
| DIMMING               | 0-10v Dimming down to 1%                  |



## LUMI SERIES | PLANE

### SUBMITTAL WORKSHEET

Order Code Example: **LMP**      - **22**      - **SC**      - **CMPOS**      - **MW**      - **OPTIONS**  
 A                                      B                                      C                                      D                                      E                                      F

#### A SERIES (CHOOSE ONE)

**LMP**                                      LUMI Series - Plane - Suspended Direct / Indirect Luminaire

#### B SIZE & OUTPUT (CHOOSE ONE)

| CODE                | POWER & LUMEN   | DISTRIBUTION                      | DIMENSION            |
|---------------------|---|-----------------------------------|----------------------|
| <b>22</b> <b>QS</b> | Field Selectable 30W - 3000lm / 40W - 4000lm / 50W - 5000lm | Edgelit 55% Direct - 45% Indirect | L24" x W24" x H0.83" |

#### C CCT - DIRECT (CHOOSE ONE)

**SC**      **QS**                                      Field Selectable 3000K / 3500K / 4000K

#### D MOUNTING

**CMPOS**      **QS**                                      8FT Power over Suspension Cable, 5.7-Inch Square Canopy  
**CMPOS-T**      **QS**                                      8FT Power over Suspension Cable, 5.7-Inch Square Canopy with T-Grid Mounting Kit  
 - see pg. 5 for detail  
 - 4" Octagon box included, adjustable T-bar clip suitable for 9/16" Flat, 9/16" Slot, 15/16" Flat T-bar grid spec

#### E FINISH

**BK**      **QS**                                      Black  
**MW**      **QS**                                      Matte White

#### F OPTIONS

**blank**                                      120~347V 0-10V 1% Dimming  
**BAA**                                      Assembled in America, Compliant with BAA (COTS)  
**CLIP-B**                                      Butterfly Clip  
**EMB-H08170\***      **QS**      Self-Diagnostic Emergency Battery 8W 100-347VAC Input 170VDC Output  
**EMB-H18170\***      **QS**      Self-Diagnostic Emergency Battery 18W 100-347VAC Input 170VDC Output

\*see pg 4 for spec

**LUMI SERIES | PLANE**

**DIMENSIONS**

| PART    | DIMENSION |     | H1    | H2    |
|---------|-----------|-----|-------|-------|
|         | W1        | W2  |       |       |
| CANOPY  | 5.7"      |     | 1.77" |       |
| FIXTURE |           | 24" |       | 0.83" |

**Canopy Mount**

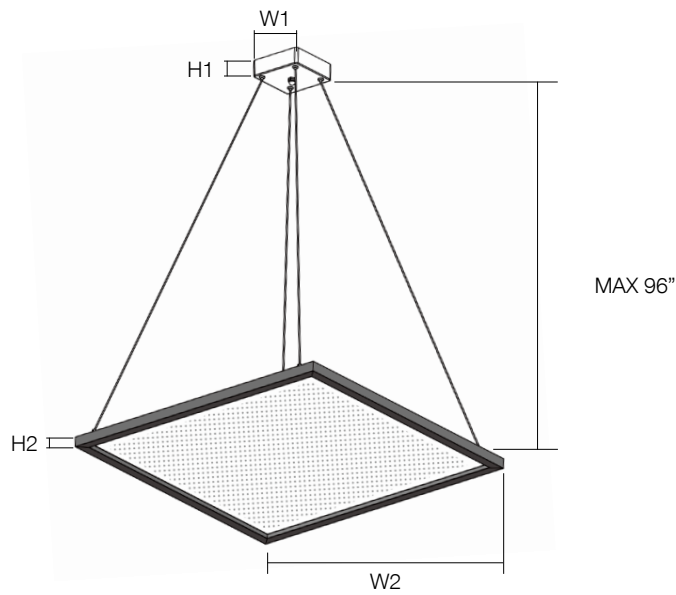

**PERFORMANCE**

Maximum Candela = 731.93  
 Located At Horizontal Angle = 0, Vertical Angle = 45  
 # 1 - Vertical Plane Through Horizontal Angles (0 - 180) (Through Max. Cd.)  
 # 2 - Horizontal Cone Through Vertical Angle (45) (Through Max. Cd.)

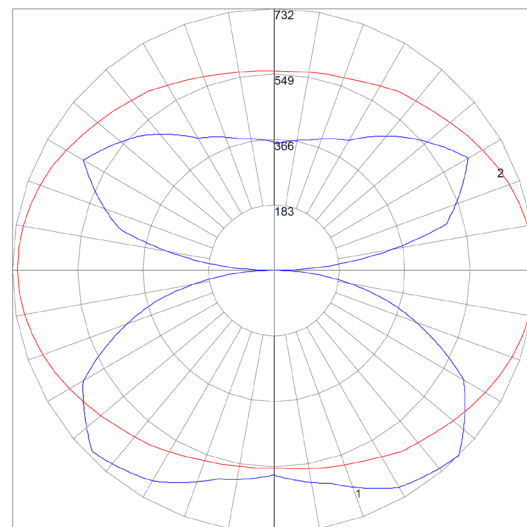

**LUMI SERIES | PLANE**

**EMB SPEC**

| Model      | Battery Capacity | Input      | Output | Output Power | Operating Temp             | Installation  |
|------------|------------------|------------|--------|--------------|----------------------------|---------------|
| EMB-H08170 | 90mins           | 100-347VAC | 170VDC | 8W           | 0°C ~ 50°C<br>32°F ~ 122°F | Field Install |
| EMB-H18170 | 90mins           | 100-347VAC | 170VDC | 18W          | 0°C ~ 50°C<br>32°F ~ 122°F | Field Install |

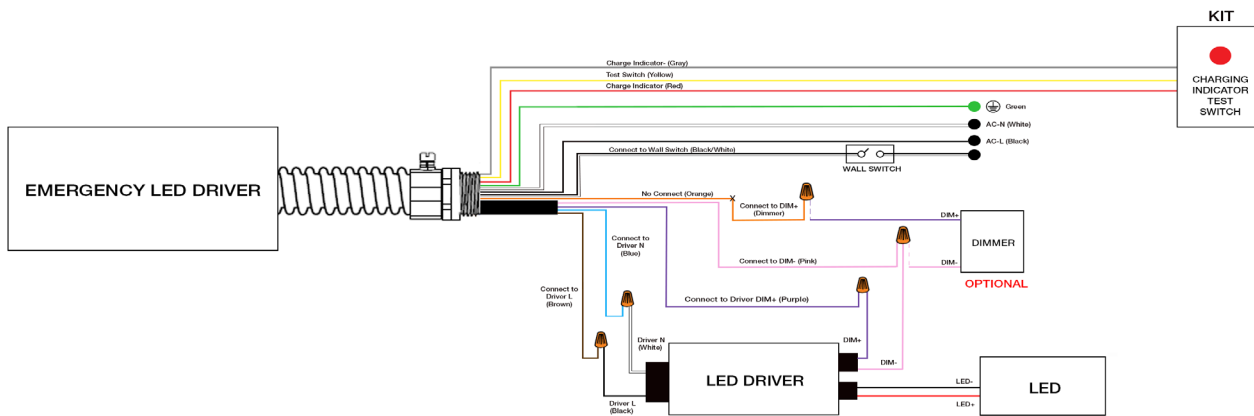

**INSTALLATION**

**Drywall / Ceiling Tile Install - CMPOS**

**Fig. 1**

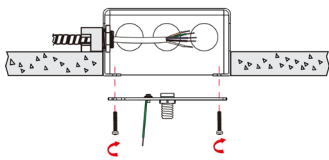

**Fig. 2**

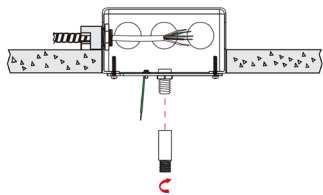

**Fig. 1:** Secure J-box crossbar onto J-box

**Fig. 2:** Screw rod extender onto J-box crossbar

**Fig. 3**

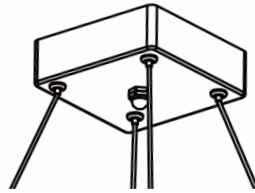

**Fig. 4**

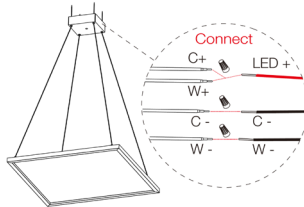

**Fig. 3:** Feed (4) POS cable through the connectors at the bottom of the canopy

**Fig. 4:** Connect (4) POS cable with driver output cables using wire nuts according to the label

**Fig. 5**

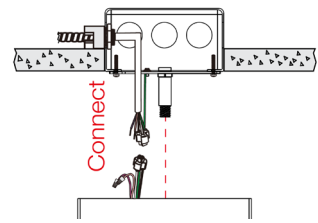

**Fig. 6**

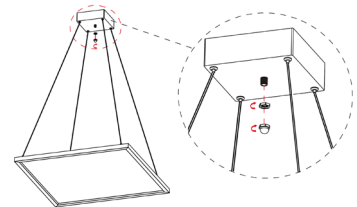
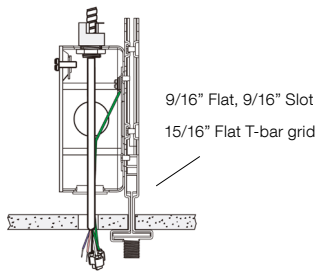

**Fig. 5:** Connect primary input through jumper with connector, use wire nuts for 0-10V dimming wires

**Fig. 6:** Position and center the canopy under rod extender, secure canopy by tighten locking nut onto rod extender

**T-Grid Install - CMPOS-T**

**Fig. 1**



**Fig. 2**

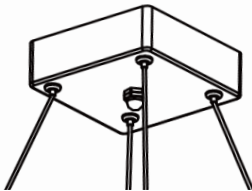

**Fig. 1:** Secure T-Grid Mounting Kit onto T-Grid system as shown

**Fig. 2:** Feed (4) POS cable through the connectors at the bottom of the canopy

**Fig. 3**

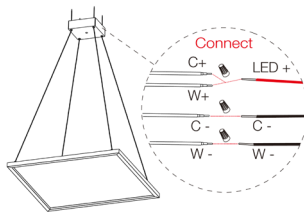

**Fig. 4**

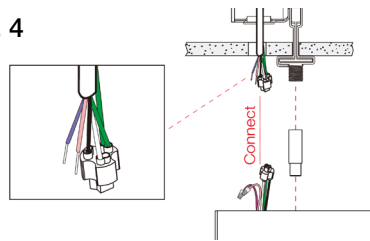

**Fig. 3:** Connect (4) POS cable with driver output cables using wire nuts according to the label

**Fig. 4:** Connect primary input through jumper with connector, use wire nuts for 0-10V dimming wires

**Fig. 5**

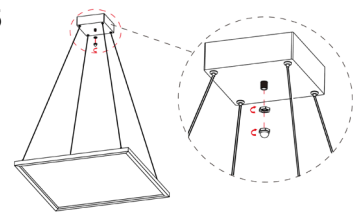

**Fig. 5:** Position and center the canopy under rod extender, secure canopy by tighten locking nut onto rod extender